

A UNIQUE SOLUTION WITH MULTIPLE BENEFITS

Electromechanical auto-ejection systems are designed to automatically release the mobile socket-outlet when a vehicle is started up.

RETTBOX® S is a professional use compact and load-breaking self-ejecting socket-outlet.

The best in class industrial socket-outlet providing power to all equipment on-board a vehicle.

RETTBOX® S complies with the following standards:

- European Low Voltage Directive and RoHS, European REACH Regulation.
- IEC/EN 61984, IEC/EN 60947-3.

20 A/32 A

RETTBOX® S SERIES

ELECTROMAGNETIC SELF-EJECTION

WITH OR WITHOUT AIR

MAKING MOBILITY SAFE

ULTRA-COMPACT FOR OPTIMISED INSTALLATION

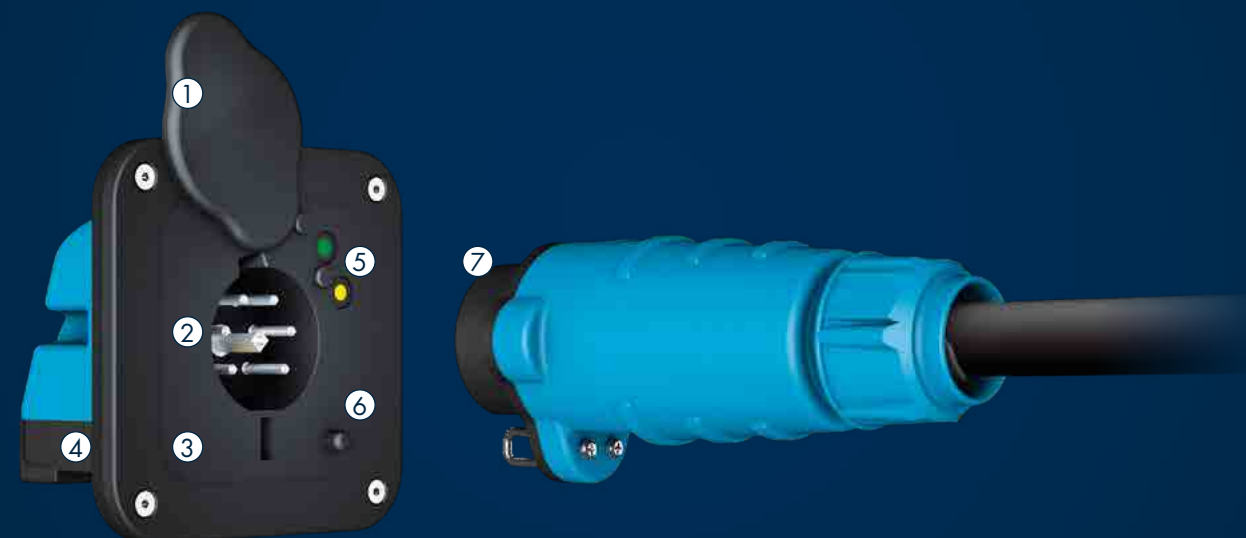

RETTBOX® S

- 1 Swivel-lid.
- 2 Base plate with 7 contacts. The air duct of the AIR version is included in the connector.
- 3 Reinforced thermoplastics box.
- 4 12V/24V solenoid coil used to eject the socket-outlet upon starting of the vehicle.
- 5 Voltage presence and battery charging light indicators.
- 6 Manual ejection push button.
- 7 Reinforced thermoplastics mobile socket-outlet.

SAFE

RETTBOX® S is the perfect response to your day-to-day safety requirements, automatically disconnecting the power supply when the vehicle is started.

SIMPLE

RETTBOX® S has been designed to make installation easy for you, and can be handled with one hand, whether you're a user, installer or body builder.

SMART

RETTBOX® S has been designed to meet your space and design constraints, thanks to the symmetry of its plate and its thinness.

POSSIBLE CONFIGURATIONS



VOLTAGE PRESENCE AND AUXILIARY BATTERY CHARGING LIGHT INDICATORS

Figure 1: with an external battery charger.
12 V DC or 24 V DC power supply.

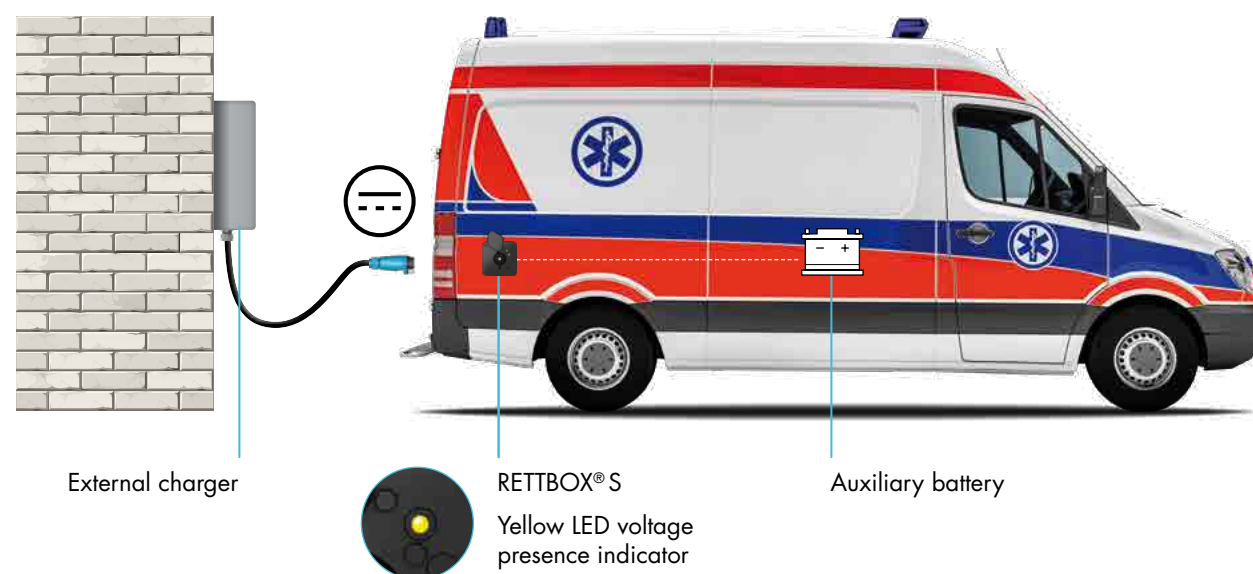
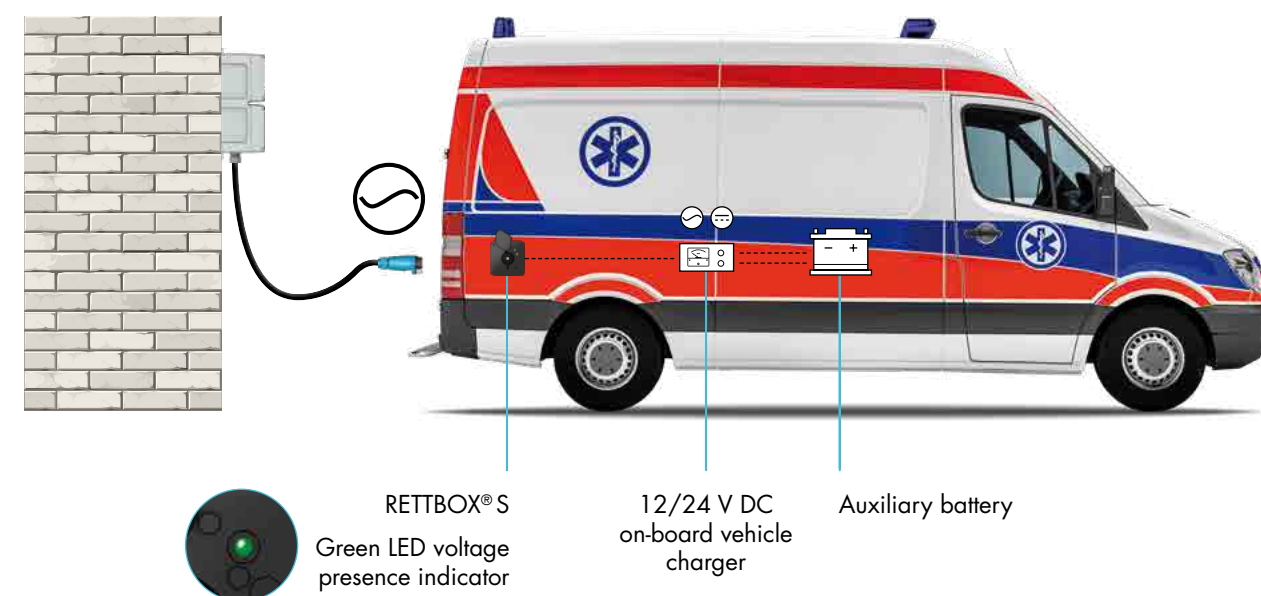
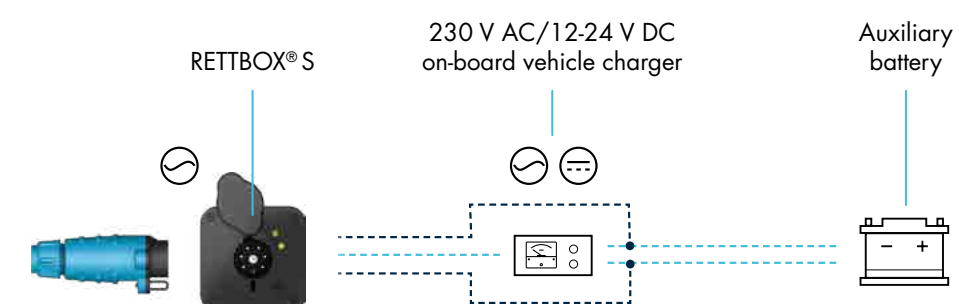

Figure 2: with an on-board vehicle charger.
up to 480 V AC power supply.



OPTIONAL

Order a
12 V DC/24 V DC
yellow LED battery
charging indicator.
Reference :
151ALED-24J



20 A/32 A

U MAX
480 V

RETTBOX®S
ELECTROMAGNETIC SELF-EJECTION
WITH OR WITHOUT AIR

INSTRUCTIONS FOR USE



IP54



1,5 - 6 mm² ⁽¹⁾



GRP



IK08



- 40 °C
+ 60 °C

(1) Flexible wiring [min.-max.]



Cable is not included

RETTBOX®S (20 A)
RETTBOX®S AIR (20 A)*

220 - 250 V AC	6P+E	With solenoid coil 12/24 V DC and male connector	1516016	1513016	15C3016
24 V DC	6P+E	With solenoid coil 12/24 V DC and male connector	1516046	1513046	15C3046
12 V DC	6P+E	With solenoid coil 12/24 V DC and male connector	1516026	1513026	15C3026

[2] Input/Cable outer Ø 5-21 mm - [3] Input/Cable outer Ø 9-18 mm, no Air version available.
* For AIR version, change the 0 of the product reference by A.



BOX*



COUPLER SOCKET
straight ^{(2)*} angled 60° ⁽³⁾



BOX*



COUPLER SOCKET
straight ^{(2)*} angled 60° ⁽³⁾



RETTBOX®S (32 A)
RETTBOX®S AIR (32 A)*

380 - 480 V AC	6P+E	With solenoid coil 12/24 V DC and male connector	1536036	1533036	15C3036
----------------	------	--	---------	---------	---------

[2] Input/Cable outer Ø 5-21 mm - [3] Input/Cable outer Ø 9-18 mm, no Air version available.
* For AIR version, change the 0 of the product reference by A.

OTHER FEATURES

	RETTBOX®S (20 A)	RETTBOX®S (32 A)	RETTBOX®S AIR (20 A)	RETTBOX®S AIR (32 A)
Box material	GRP	GRP	GRP	GRP
Front dimensions (W x H) in mm	120 x 120	120 x 120	120 x 120	120 x 120
IP Box	IP54	IP54	IP54	IP54
IP : mobile socket-outlet without plug cap	IP2X	IP2X	IP2X	IP2X
IP : mobile socket-outlet with plug cap	IP44	IP44	IP44	IP44
Cut-out dimensions on vehicle's frame (W x H x D) in mm	86 x 82 x 83	86 x 82 x 83	86 x 82 x 83	86 x 82 x 83
Weight (excluding coupler socket)	400 g	400 g	407 g	407 g
AIR Version	/	/	up to 13 bars	up to 13 bars

OPTIONS



Order a 12/24 V yellow LED battery charging indicator.
Reference : 151ALED-24J.



Contact us for wall installation
with a box 120x120x91.

Cable available per meter

381AKOM : 32 A cable, 1 air duct
+ 5G6mm² (4P+E) + 2 x 2.5mm² for auxiliaries

611AKOM: 20 A cable, 1 compressed air duct
+ 4G2.5mm² (3P+E) + 2 x 1.5mm² for auxiliaries

DRAWINGS
AND DIMENSIONS

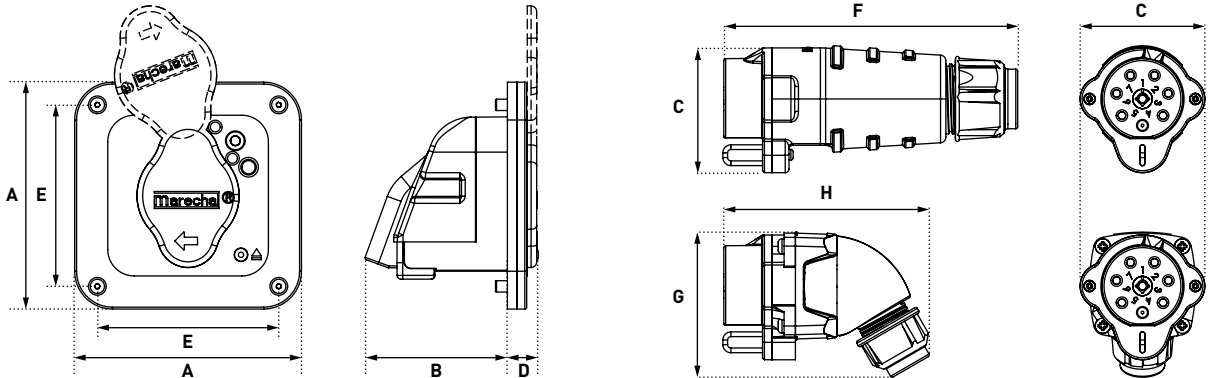

A	B	C	D	E	F	G	H
120	75	66	16	96	156	77	109



DOWNLOAD
THE DRAWINGS
ON OUR WEBSITE
marechal.com

RETTBOX® ONE SERIES

ELECTROMAGNETIC SELF-EJECTION

RETTBOX® ONE complies with the following standards:

- European Low Voltage Directive and RoHS, European REACH Regulation.
- IEC/EN 60309-1 and IEC/EN 60670.



RETTBOX® ONE

- 1 Self-closing sliding cover.
- 2 Mobile plug with IP55 self-returning lid.
- 3 Male inlet 2 to 6 contacts. The air duct of the AIR version is included in the connector.
- 4 RETTBOX® ONE 20 A: casing in GRP.
- 5 Electric solenoid 12/24 V providing automatic ejection when the engine is started.

INFOS +

ENSURE SPEED AND SAFETY

- 1 Loading box connected to the electrical system of the vehicle.
- 2 Automatic ejection of the coupler socket upon start-up of the vehicle by way of an electric solenoid.
- 3 Protection against water and dust by means of a self-closing cover.

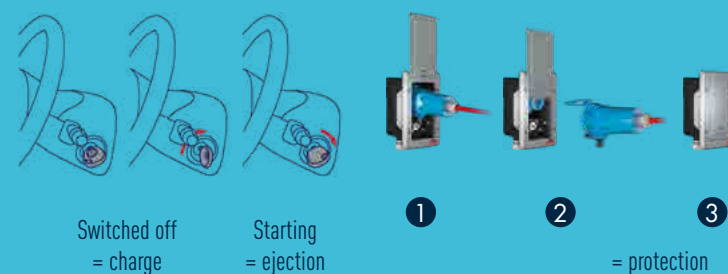

FIND ALL THE
INFORMATION
ABOUT THE
RETTBOX® ONE
ON OUR YOUTUBE
CHANNEL



CONNECTION DIAGRAM BY TYPE

Power supply with 230 V AC or 400 V AC on-board battery charger.



- 1 Starter key.
- 2 RETTBOX® ONE.
- 3 Mobile plug and RETTBOX® ONE cable.
- 4 Auxiliary battery.
- 5 12/24 V DC on-board vehicle charger.

20 A

RETTBOX® ONE
ELECTROMAGNETIC SELF-EJECTION

U MAX
440 V

INSTRUCTIONS FOR USE



IP55



1,5 - 6 mm² ⁽¹⁾



GRP
STAINLESS
STEEL



IK08
IK10



- 40 °C
+ 60 °C



2 AUX.

[1] Flexible wiring [min.-max.]



ENCLOSURE with inlet
supplied with 4 m cable ⁽²⁾

COUPLER SOCKET
pre-wired, cable
4 m included ⁽²⁾

RETTBOX® ONE

220 - 250 V AC	1P+N+E	With 12 V relay and male inlet	6116015RK412U	6113015RK4L
220 - 250 V AC	1P+N+E	With 24 V relay and male inlet	6116015RK424U	6113015RK4L
220 - 250 V AC	1P+N+E+2 aux.	With 12 V relay and male inlet	6116175RK412U	6113175RK4L
220 - 250 V AC	1P+N+E+2 aux.	With 24 V relay and male inlet	6116175RK424U	6113175RK4L
24 V DC	2P DC*	With 24 V relay and male inlet	6116089RK424U	6113089RK4L
12 V DC	2P DC*	With 12 V relay and male inlet	6116059RK412U	6113059RK4L

*LED not available for these configurations.

[2] All versions are available in 4 and 8 m, contact us for the references.

OTHER FEATURES

	RETTBOX® ONE (20 A)
Front	stainless steel
Box	GRP
Front dimensions (W x H) in mm	114 X 184
Cut-out dimensions on vehicle's frame (W x H x D) in mm	83 X 163 x 94
Auxiliary contacts in option	2 Aux
Weight (excluding coupler socket)	1 200 g
Built-in DECONTACTOR™	20 A



INFOS +

LED CONTROL LIGHT

RETTBOX® ONE (20 A, 230 V)
feature a LED signal light
that indicates the presence of
charging voltage.

OPTIONS

Reference

LEATHER PULL-GRIP (COUPLER SOCKET)



611AZIE

CEILING BRACKET MADE OF STAINLESS STEEL



RETTBOX® ONE 20 A

611AHUTRRR L

DRAWINGS
AND DIMENSIONS

	A	B	C	D	E	F	G	H	J
RETTBOX® ONE 20 A	184	114	184	89	114	163	94	152	83

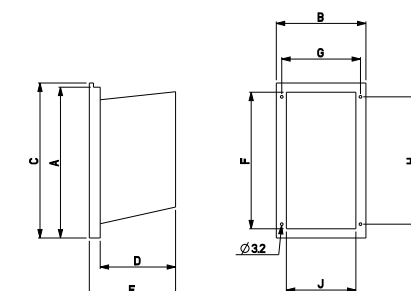

DOWNLOAD
THE DRAWINGS
ON OUR WEBSITE
marechal.com

20 A

U MAX
440 V

RETTBOX® ONE AIR
ELECTROMAGNETIC SELF-EJECTION

INSTRUCTIONS FOR USE



IP55



1,5 - 6 mm² ⁽¹⁾



GRP
STAINLESS
STEEL



IK08
IK10



- 40 °C
+ 60 °C



2 AUX.

[1] Flexible wiring [min.-max.]



ENCLOSURE with inlet supplied
with 4 m cable - compressed air
conduct up to 13 bars⁽²⁾



**COUPLER
SOCKET**
pre-wired, cable
4 m included ⁽²⁾

RETTBOX® ONE AIR

220 - 250 V AC	1P+N+E	With 12 V relay and male inlet	6116015AK412U	6113015AK4L
220 - 250 V AC	1P+N+E	With 24 V relay and male inlet	6116015AK424U	6113015AK4L
220 - 250 V AC	1P+N+E+1 aux.	With 12 V relay and male inlet	6116215AK412U	6113215AK4L
220 - 250 V AC	1P+N+E+1 aux.	With 24 V relay and male inlet	6116215AK424U	6113215AK4L
24 V DC	2P DC*	With 24 V relay and male inlet	6116089AK424U	6113089AK4L
12 V DC	2P DC*	With 12 V relay and male inlet	6116059AK412U	6113059AK4L
Cable only (per metre): 611AKOM				

*LED not available for these configurations.

[2] All versions are available in 4 and 8 m, contact us for the references.

OTHER FEATURES

RETTBOX® ONE AIR (20 A)	
Front	stainless steel
Box	GRP
Front dimensions (W x H) in mm	114 X 184
Cut-out dimensions on vehicle's frame (W x H x D) in mm	83 X 163 x 94
Auxiliary contacts in option	1 Aux
Weight (excluding coupler socket)	1 200 G
Built-in DECONTACTOR™	20 A
Compressed air duct	up to 13 bars



INFOS +

LED CONTROL LIGHT

RETTBOX® ONE AIR (20 A, 230 V)
feature a LED signal light that
indicates the voltage presence.

OPTIONS

Reference

LEATHER PULL-GRIP (COUPLER SOCKET)



611AZIE

CEILING BRACKET MADE OF STAINLESS STEEL



RETTBOX® ONE AIR 20 A

611AHUTAAA L

CABLE AVAILABLE PER METRE

20 A cable,
1 compressed air
conduit + 4g 2.5 mm²
(3P+E) + 2 x 1.5 mm²
for auxiliaries.

611AKOM

DRAWINGS
AND DIMENSIONS

RETTBOX® ONE AIR 20 A	A	B	C	D	E	F	G	H	J
	184	114	184	89	114	163	94	152	83

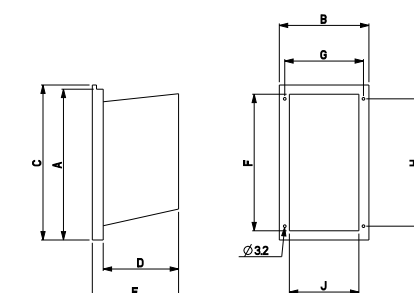

DOWNLOAD
THE DRAWINGS
ON OUR WEBSITE
marechal.com